

## WHIRL GRIT CLASSIFIER DF SW

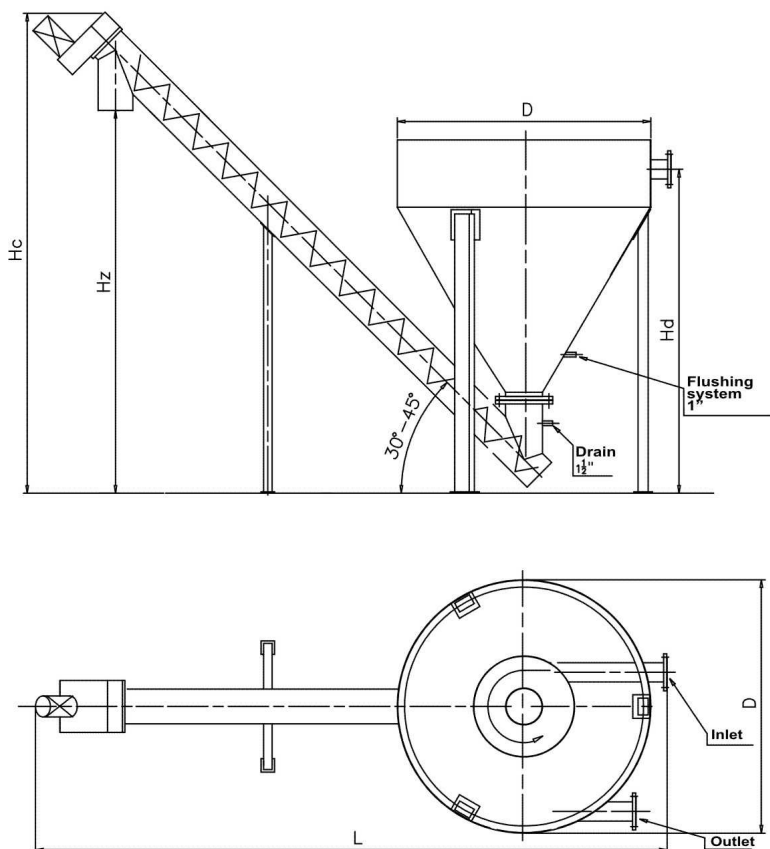

### APPLICATION

The whirl grit classifier DF SW is intended for final grit separation from the water-grit pulp supplied from the grit separator. After minor design modifications, it can be very well used by small wastewater treatment facilities as a whirl grit separator with grit removal by screw conveyor.

### PRINCIPLE OF OPERATION

The wastewater (water-grit mixture) enters the unit via inlet port and is made whirl to increase the effectiveness of the grit separation process. Leaving the inner ring, the pulp quiets in a separation chamber; the sand falls down by gravity to the bottom while the excess of fluid suspension flows to the top and is led out via overflow pipe. Screw-type shaft conveyor moves the water-soaked grit from the bottom of the tank to the outside and draining at the same the water from the grit

The inlet and outlet port locations are selected each time to the site requirements. Thermal insulation and heating system enable outside installation of the unit. As standard, the whirl grit classifier DF SW is made of stainless steel and plastics.

### OPTIONS

- waster grit washing installation
- thermal insulation and heating system
- hermetic cover

### SPECIFICATIONS

VERSION			DF SW 1	DF SW 2	DF SW 3
Hydraulic load		m <sup>3</sup> /h	25	45	65
Fixed weight load		m <sup>3</sup> /h	1,1	2,2	3,0
Driving motor power	P	kW	1,1 ÷ 1,5	1,5	1,75
Outer diameter (width)	D	mm	1000	1500	2000
Screw conveyor diameter	S	DN	150	200	200
Total length	L	mm	3740/3315/2960	4835/4255/3770	5700/5010/4470
Total height	Hc	mm	2280/2330/2390	2865/2855/2860	3310/3335/3390
Screw conveyor inclination	$\alpha$	°	35/40/45	35/40/45	35/40/45
Grit discharge height	Hz	mm	1700	2275	2605
Influent height	Hd	mm	1350	1925	2255
Effluent height	Ho	mm	1100	1600	1855
Weight	m	kg	290	350	700
Capacity	V	dm <sup>3</sup>	400	1400	2700
Heating power	Po	W	850	1200	1500
Influent connection diameter	d1	DN	80	100	150
Effluent connection diameter	d2	DN	100	150	200
Amount of water for flushing	Q	dm <sup>3</sup> /min	16	19	24
Pressure of water for flushing	p <sub>w</sub>	bar	4	4	4

On request, the unit can be modified to customer's requirements.